

FebriDx[®]

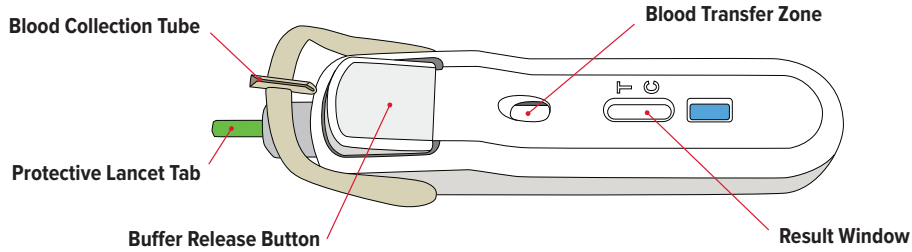

TEST PROCEDURE

Use standard precautions for collecting and handling a fingerstick blood sample.

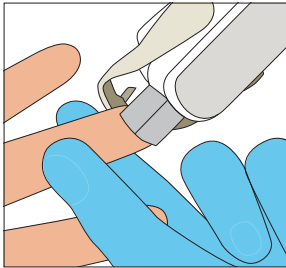

1 Lance Finger

Twist and pull to remove the green **Protective Lancet Tab**.

Firmly press the lancet to puncture the skin.

Wipe away the first drop of blood.

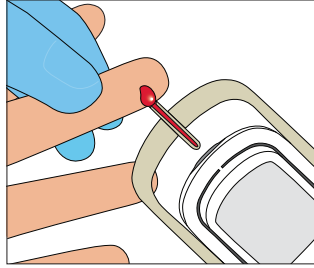

2 Collect Blood

Gently massage the finger to encourage blood flow to obtain a drop of blood that hangs from the finger.

Place the **Blood Collection Tube** at a 45 degree angle below the finger, making contact with the hanging drop of blood. Avoid direct contact with the patient's finger.

Fill the **Blood Collection Tube** completely.

Gently squeeze the finger to add more blood if necessary. **The Blood Collection Tube must be full.**

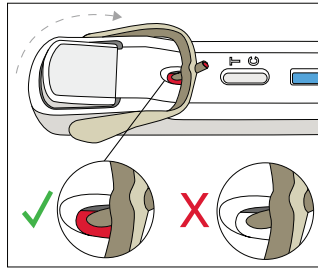

3 Deliver Blood

Rotate the **Blood Collection Tube** over the **Blood Transfer Zone** allowing it to lock into position.

Wait for most of the blood to transfer to the **Blood Transfer Zone** (~ 5-10 seconds).

If the blood does not immediately begin to transfer, reverse the **Blood Collection Tube** back to its original position and ensure the tube is completely full before rotating back onto the **Blood Transfer Zone**.

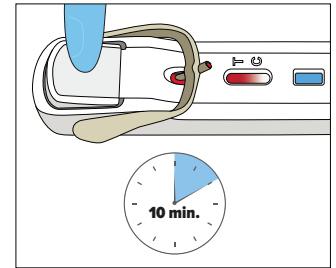

4 Deliver Buffer

Lay test on a flat surface.

Activate the test by firmly and fully pressing the **Buffer Release Button**.

If no fluid is visible within 25-30 seconds, firmly re-press the **Buffer Release Button**.

Wait for 10 minutes. Results will appear in the **Result Window**. Do not read results after 1 hour.

How to Read FebriDx Results

A **blue control line** must appear in the result window for the test to be valid.

Bacterial Infection	Viral Infection	Negative Result
Black Only Result Line	Any Red Result Line	No Result Line
<p>CRP </p> <p>MxA </p> <p>CTR </p>	<p>CRP </p> <p>MxA </p> <p>CTR </p>	<p>CRP </p> <p>MxA </p> <p>CTR </p>
Bacterial Infection	Viral Infection	Negative Result

Important Notes

Test operators should review the FebriDx Package Insert and read the complete procedure before performing the test.

Even if result line is faint in color, incomplete over the width of the result window, or uneven in color, it should be interpreted as positive.

If there is no blue control line, the test is invalid.

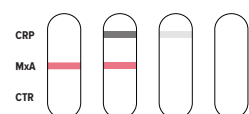

FebriDx[®]

EXTERNAL CONTROL PROCEDURE

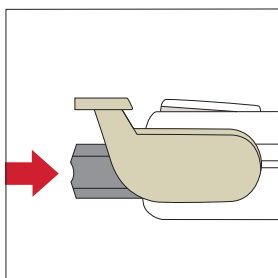

1 Deploy Lancet

Twist and pull to remove the **Protective Lancet Tab**. Firmly press the lancet on a hard surface to move past the patient sampling step.

Take care not to make skin contact with the lancet.

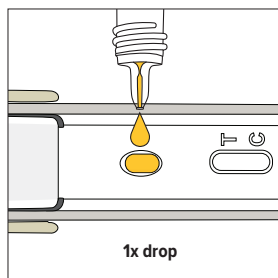

2 Add 1 Drop of Control

Locate either the **Positive** or **Negative Control** vial and remove the cap.

Hold the control vial vertically over the **Blood Transfer Zone**.

Do not touch the tip of the dropper vial onto the surface of the test.

Squeeze to release one drop of liquid, allowing the drop to fall freely onto the **Blood Transfer Zone**.

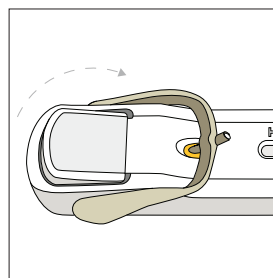

3 Rotate Blood Collection Tube

Rotate the **Blood Collection Tube** over the **Blood Transfer Zone** until it clicks into position. Wait 5-10 seconds before activating the test.

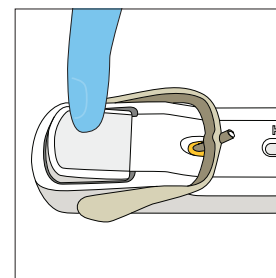

4 Deliver Buffer Solution

Lay test on a flat surface.

Activate the test by firmly and fully pressing the **Buffer Release Button** to deliver the buffer.

If no fluid is visible within 25-30 seconds, firmly re-press the **Buffer Release Button**.

Wait for 10 minutes. Results will appear in the **Result Window**.



Important Notes

Test operators should review the FebriDx External Controls Package Insert and read the complete procedure before performing the test.

The FebriDx test also has an internal control. Refer to the FebriDx Package Insert for more information on Quality Control.

The FebriDx test is designed to proceed in sequential order and locking mechanisms exist to prevent skipping the prior step. Therefore it is essential to incorporate all the test steps in order.

Positive Control will produce both CRP and MxA result lines.

Negative Control will **not** produce either a CRP or MxA result line.

Visit FebriDx.com for more information.

For technical assistance or customer support call +1.941.556.1850

Reference the FebriDx Package Insert for Warnings and Precautions, Specimen Collection and Handling, and Quality Control.



Manufacturer and United States Representative:

 Rapid Pathogen Screening, Inc. • 7227 Delainey Court • Sarasota, FL 34240 USA • +1.941.556.1850 • FebriDx.com

Lumos Diagnostics is a trade name of Lumos Diagnostics Holdings PTY LTD. Rapid Pathogen Screening, Inc. is a wholly owned subsidiary of Lumos Diagnostics Holdings PTY LTD. ©2021 Rapid Pathogen Screening, Inc. All rights reserved.